

NOTE: HOLLOW CORE CONCRETE PLANK SYSTEM. NO CORING, CHIPPING OR DRILLING IS ALLOWED UNTIL VERIFIED, REVIEWED AND APPROVED BY THE DESIGN TEAM.

PROVIDE PROPOSED PENETRATION LOCATIONS FROM UNDERSIDE OF FLOOR FOR REVIEW AND APPROVAL.

FIRST FLOOR PLAN - DEMO 1/8" = 1'-0" 1

**KEYNOTES**

- 1 DEMO EXISTING WALL BASE.
- 2 DEMO EXISTING FLOORING AND WALL TILE. PREP FOR NEW FLOORING AND FINISHES, AS REQUIRED FOR NEW CONSTRUCTION.
- 3 DEMO EXISTING COUNTER TOPS, SHELVING, AND MILLWORK.
- 4 DEMO EXISTING CEILING ASSEMBLY, LIGHT FIXTURES, AND ALL CEILING-MOUNTED DEVICES.
- 5 DEMO EXISTING WALL AND WALL MOUNTED EQUIPMENT; REFER TO MEP FOR TERMINATING AND/OR REROUTING MEP SYSTEMS. WALLS AND CEILINGS TO BE DEMOED ONLY.
- 6 REMOVE ALL EXISTING WALL MOUNTED ACCESSORIES. SALVAGE FOR REUSE, IF INDICATED ON NEW WORK.
- 7 DEMO EXISTING WALL OR PORTION THEREOF. PREP FOR NEW WALL AND OPENING, IF INDICATED ON NEW WORK PLANS. VERIFY LOCATION AND SIZE OF OPENING WITH PLANS SHOWING NEW WORK.
- 8 EXISTING DOORS TO REMAIN. PROTECT DURING CONSTRUCTION OF NEW WORK.
- 9 REMOVE EXISTING BENCHES. SALVAGE FOR REUSE AS INDICATED ON NEW WORK.
- 10 EXISTING DOOR AND FRAME TO REMAIN. PAINT BOTH SIDES OF DOOR AND FRAME. PREP AND SAND AS REQ'D.
- 11 DEMO EXISTING TOILET PARTITIONS. SALVAGE FOR REUSE. PROVIDE TO OWNER.
- 12 DEMO EXISTING PLUMBING FIXTURE(S); REFER TO MEP. PREP TO REPLACE WITH NEW AS SHOWN ON NEW WORK PLANS.
- 13 DEMO EXISTING TOILET AND BATH ACCESSORIES AS INDICATED. SALVAGE FOR REUSE. PROVIDE TO OWNER.
- 14 EXISTING TOILET GRAB BARS TO BE REMOVED AND REINSTALLED AS INDICATED ON NEW WORK PLAN. SALVAGE FOR REUSE. PROVIDE TO OWNER.
- 15 REMOVE EXISTING WALL SHELVES AND MIRRORS. SALVAGE FOR REUSE AS INDICATED ON NEW WORK.
- 16 REMOVE ALL EXISTING WALL-MOUNTED EQUIPMENT INCLUDING BUT NOT LIMITED TO SHELVING, HOOKS, AND BRACKETS. SALVAGE FOR REUSE. PROVIDE TO OWNER.
- 17 REMOVE EXISTING CEILING TILES AS REQUIRED FOR NEW WORK. SALVAGE AND STORE FOR REUSE AS INDICATED ON NEW WORK.

**GENERAL NOTES**

1. BACKGROUND DRAWINGS ARE BASED ON ORIGINAL CONSTRUCTION DOCUMENTS. PLEASE VERIFY ALL CONDITIONS AND DIMENSIONS PRIOR TO CONSTRUCTION. REPORT ANY DISCREPANCIES TO THE ARCHITECT.
2. EXISTING CONDITIONS DAMAGED OR REMOVED AS A RESULT OF ALL WORK REQUIRED TO BE DONE UNDER THIS CONTRACT SHALL BE REPAIRED OR REPLACED TO ORIGINAL CONDITION AND FINISHED TO MATCH ADJACENT SURFACES.
3. DEMOLITION CONTRACTORS ARE TO CONSULT CLOSELY WITH MECHANICAL, ELECTRICAL, AND PLUMBING CONTRACTORS PRIOR TO COMMENCEMENT OF DEMOLITION.
4. DUE TO THE POSSIBILITY OF DISCOVERING UNFORESEEN CONDITIONS DURING DEMOLITION, IT SHALL BE THE RESPONSIBILITY OF THE CONTRACTOR TO STUDY THE FULL INTENT OF REQUIRED DEMOLITION BY INCORPORATING A COMPLETE ANALYSIS OF THE PROPOSED NEW CONSTRUCTION.
5. EACH AREA OF DEMOLITION IS TO BE CLEAR OF DEBRIS AND IS TO BE SWEEPED CLEAN. METHOD OF DEBRIS REMOVAL MUST BE IDENTIFIED BY THE CONTRACTOR AND APPROVED BY THE BUILDING OWNER.
6. THE GENERAL CONTRACTOR IS RESPONSIBLE FOR CHECKING CONSTRUCTION DOCUMENTS AND FIELD CONDITIONS FOR ACCURACY AND CONFIRMING THAT THE WORK CAN BE DONE AS SHOWN, BEFORE PROCEEDING WITH THE DEMOLITION. IF THERE ARE COORDINATION QUESTIONS, THE CONTRACTOR IS RESPONSIBLE FOR OBTAINING A CLARIFICATION FROM THE DESIGNER BEFORE PROCEEDING WITH THE WORK IN QUESTION.
7. ALL PENETRATIONS MADE TO FLOOR SLABS DURING DEMOLITION/REMODEL OPERATIONS, OR EXISTING PENETRATIONS, SHALL BE FIRE RATED WITH U.L. APPROVED MATERIALS AND METHODS TO MAINTAIN EXISTING FIRE RATINGS. ALL EXISTING PENETRATIONS FOUND TO BE NON-COMFORMING SHALL ALSO BE FIRE-SAFE AS PART OF THIS PROJECT.
8. PROTECT ALL AREAS NOT SCHEDULED FOR DEMOLITION/MODIFICATION.
9. WHERE DEMOLITION OCCURS, PATCH, SAND, PREP, TEXTURE, AND REPAIR REMAINING CONSTRUCTION TO MATCH EXISTING FINISH.

**LEGEND**

- EXISTING WALL TO REMAIN
- WALLS OR PORTION OF WALLS TO BE REMOVED
- EXISTING DOOR AND FRAME TO REMAIN
- DOOR AND FRAME TO BE REMOVED

**KEYPLAN**

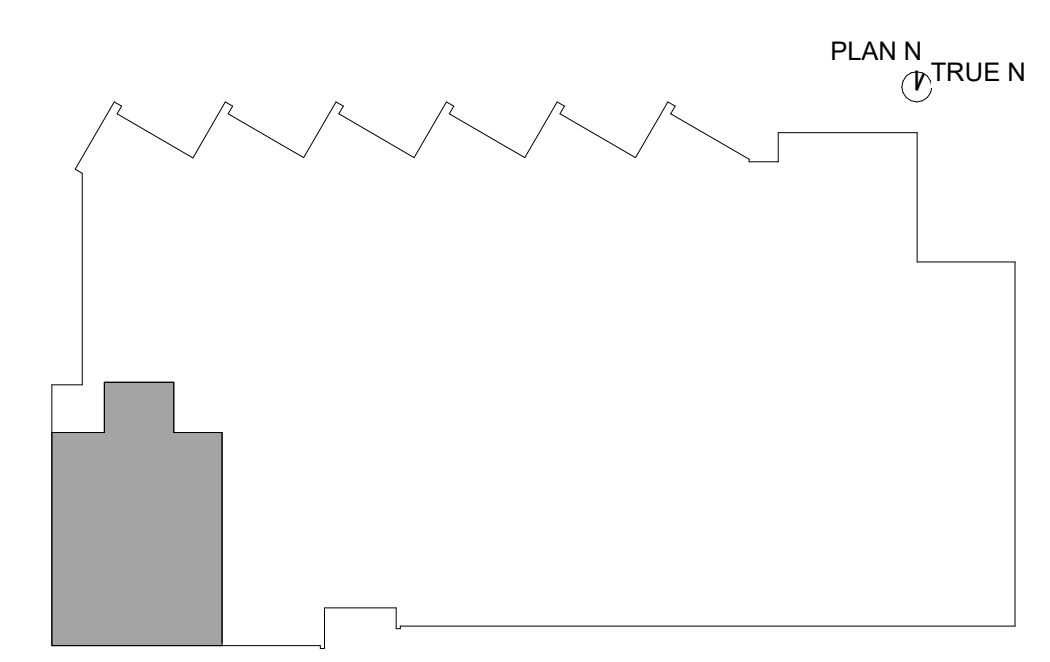

This set of drawings is the property of LPA and shall remain the property of LPA. It is to be used only for the project and site identified herein. It is not to be reproduced, stored in a retrieval system, or transmitted in any form or by any means, electronic, mechanical, photocopying, recording, or by any information storage and retrieval system, without the prior written permission of LPA. LPA shall not be liable for any errors or omissions in these drawings. The contractor shall verify all dimensions and conditions before construction and the existing conditions.

© Copyright 2017

Date	
Revision	
Date	
Quantity	
Job No.	1762510
Date	Issue Date
Checked by	Checker
Scale	1/8" = 1'-0"

**FLOOR PLAN - DEMOLITION**