

REVISED ISSUE DATES:

_____	▲
_____	▲
_____	▲

**BUSH'S CHICKEN !**  
BLANCO & BITTERS  
SAN ANTONIO, TX. 78216

**SITE PLAN**



THIS DRAWING IS PROVIDED AS AN INSTRUMENT OF SERVICE BY THE ARCHITECT AND IS INTENDED FOR USE ON THIS PROJECT ONLY. THE DRAWING REMAINS THE PROPERTY OF THE ARCHITECT AND SHALL BE RETURNED TO HIM/HER UPON COMPLETION OF THE CONSTRUCTION WORK. PURSUANT TO THE ARCHITECTURAL WORKS COPYRIGHT PROTECTION ACT OF 1990, ALL DRAWINGS, SPECIFICATIONS, IDEAS AND DESIGNS, INCLUDING THE OVERALL FORM, ARRANGEMENT AND COMPOSITION OF SPACES AND ELEMENTS APPEARING HEREIN, CONSTITUTES THE COPYRIGHTED WORK OF THE ARCHITECT. ANY REPRODUCTION, USE, OR DISCLOSURE OF INFORMATION CONTAINED HEREIN WITHOUT PRIOR WRITTEN CONSENT OF THE ARCHITECT IS STRICTLY PROHIBITED.  
© 2015

PROJECT NO. 15-054  
ISSUE DATE: 12-17-15  
DRAWN BY: AT/SM  
REVIEWED BY: RM  
PROJECT ARCHITECT:  
GABRIEL DURAND-HOLLIS, FAIA  
TEXAS LICENSE NO. 10881

**SP100**

**KEYED NOTES:**

1. NEW CONCRETE CURB, REF. CIVIL
2. NEW ASPHALT PAVEMENT, REF. CIVIL
3. NEW ASPHALT PAVEMENT, REF. CIVIL
4. HANDICAP SIGN POLES, REF. CIVIL
5. BIKE RACKS
6. 6'-0" HEIGHT WOOD SCREEN FENCE, STAINED
7. WOOD BLOCKING AS REQUIRED
8. STEEL TUBE DUMPSTER GATE, TAINTED
9. STEEL PIPE WITH CONCRETE BOLLARD IN BACK OF TRASH ENCLOSURE
10. DUMPSTER ENCLOSURE
11. CONCRETE FOOTING
12. EXISTING CONCRETE CURB TO DEMO
13. EXISTING ASPHALT
14. EXISTING CONCRETE CURB TO REMAIN
15. CONCRETE WHEEL STOPS, REF. CIVIL
16. TRUNCATED DOMES, REF. CIVIL

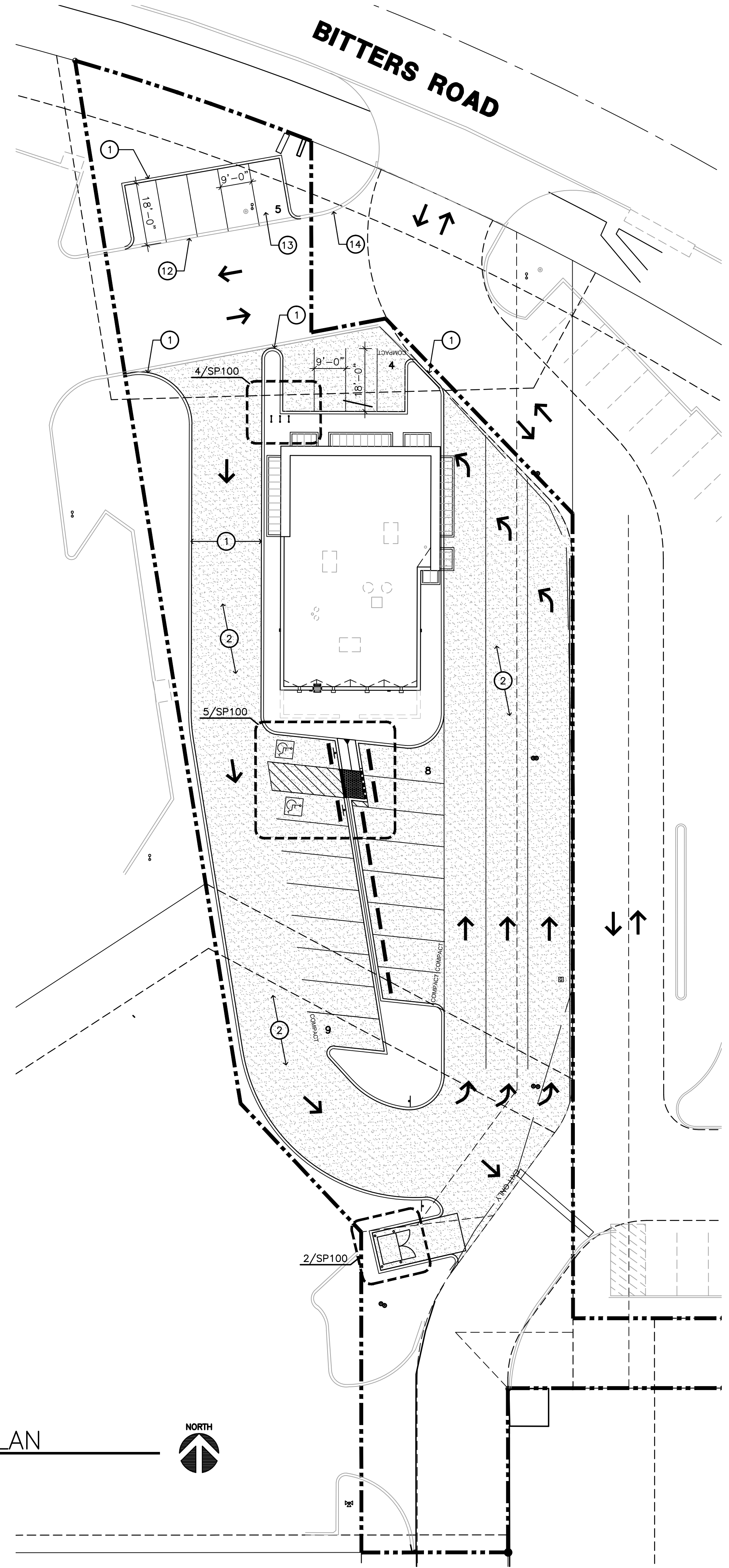

**1 SITE PLAN**  
SCALE: 1"=20'-0"

**4 BIKE RACK PLAN**  
SCALE: 1/4"=1'-0"

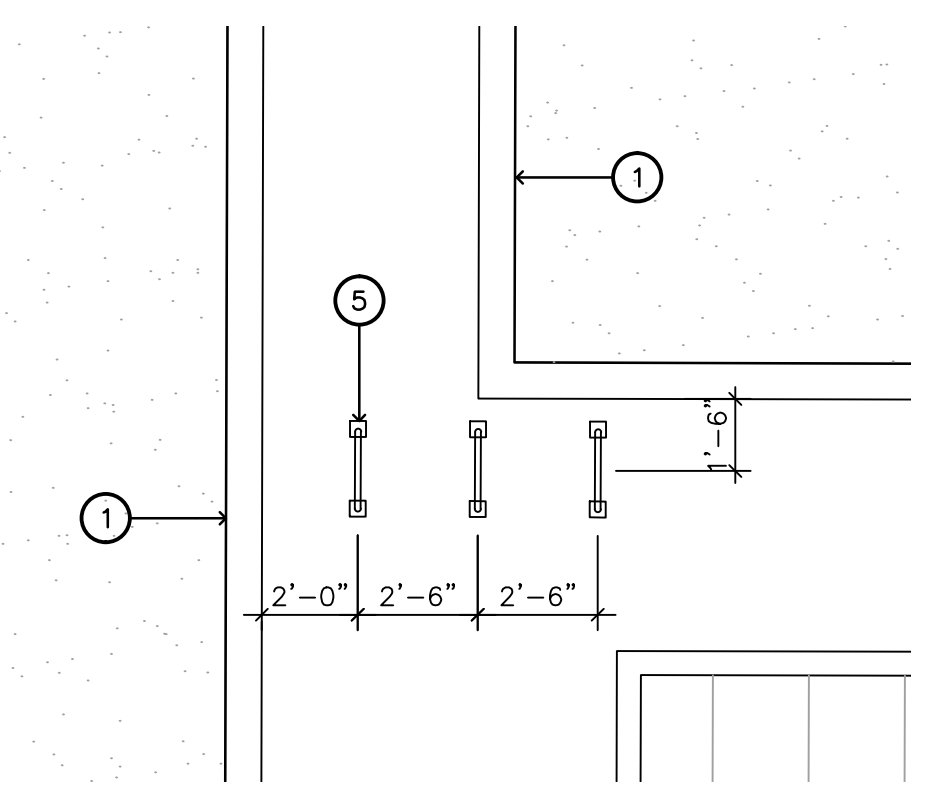

**2 DUMPSTER PLAN**  
SCALE: 1/4"=1'-0"

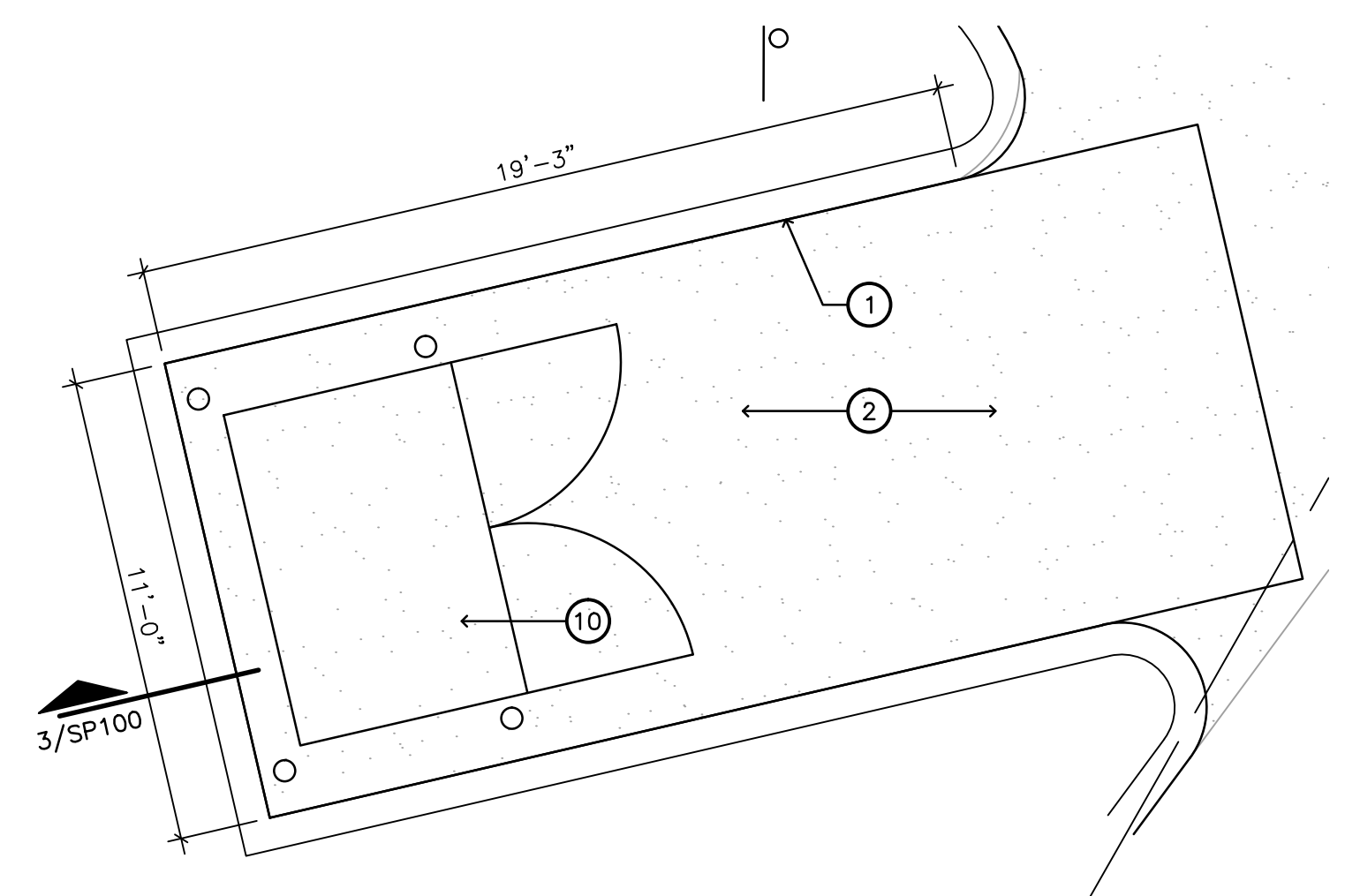

**3 GATE SECTION**  
SCALE: 1"=1'-0"

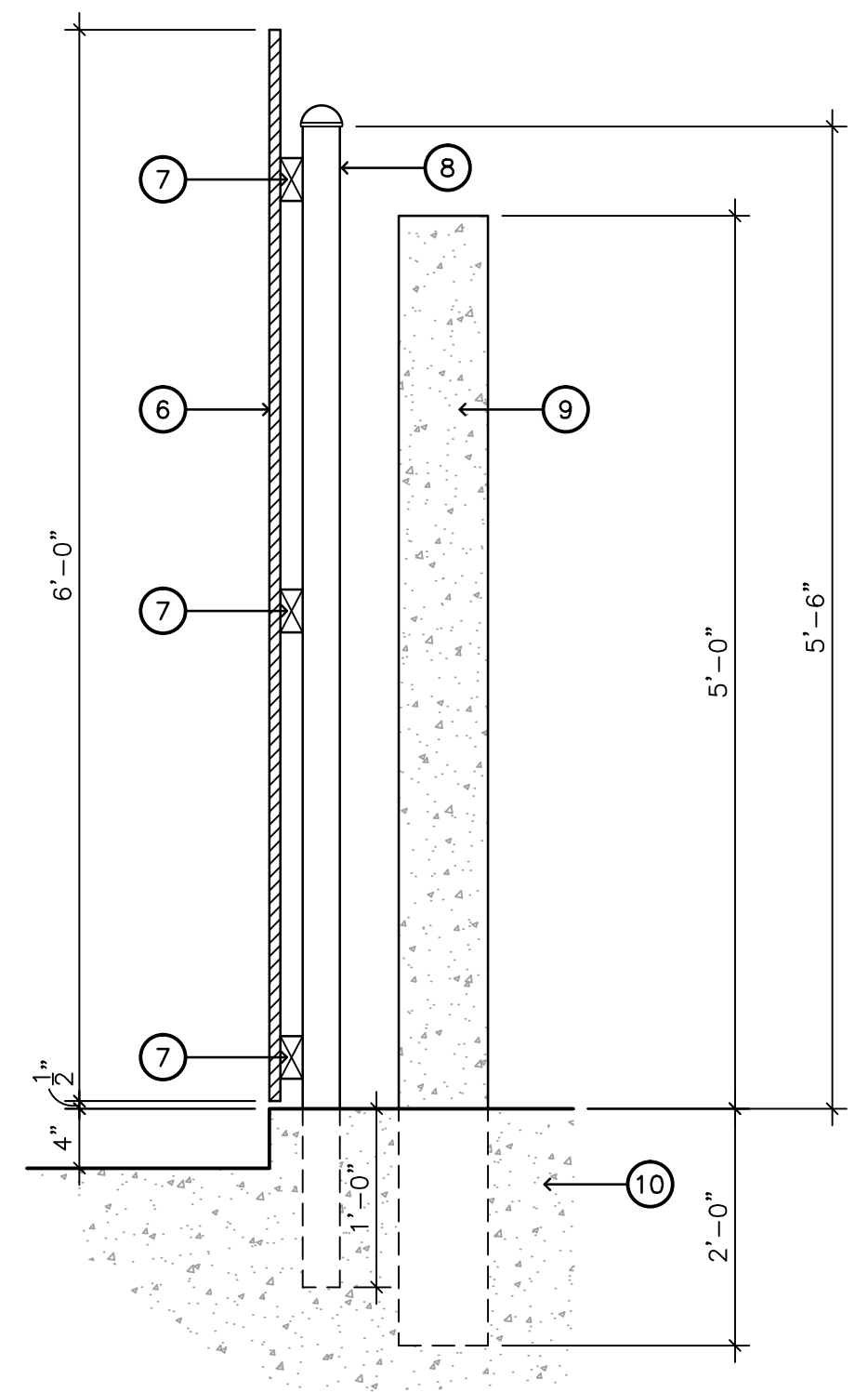

**5 HANDICAP STALLS**  
SCALE: 1/4"=1'-0"

